

## INSTALLATION AND USER GUIDE WARMOS WALO, WARMA AND WAHVA HEATERS (IP34, 230V)

You can find more information about Walo, Warma and Wahva heaters by scanning these QR codes:

Walo series:



Warma series:



Wahva series:



The trendy 20cm high Walo, stylish 40cm high Warma and timeless 60cm high Wahva heaters are all wall-mounted and they have an ingress protection rating IP34.



Series and	Width mm	Height mm	Power W	Brackets' mounting hole distance	Product no.
<b>Walo</b>					
EW205	600	200	500	305	8123903
EW208	1000	200	800	590	8123904
EW210	1300	200	1000	790	8123905
EW212	1600	200	1200	935	8123907



Series and	Width mm	Height mm	Power W	Brackets' mounting hole distance	Product no.
<b>Warma</b>					
EW402	360	400	200	125	8123909
EW403	560	400	350	325	8123911
EW405	720	400	500	405	8123913
EW408	1120	400	800	720	8123914
EW410	1440	400	1000	965	8123915
EW412	1720	400	1250	1160	8123916
<b>Wahva</b>					
EW605	560	600	500	405	8123920
EW608	880	600	800	560	8123921
EW610	1120	600	1000	720	8123922
EW612	1440	600	1250	965	8123924
EW615	1720	600	1500	1160	8123926

## Wall mounting

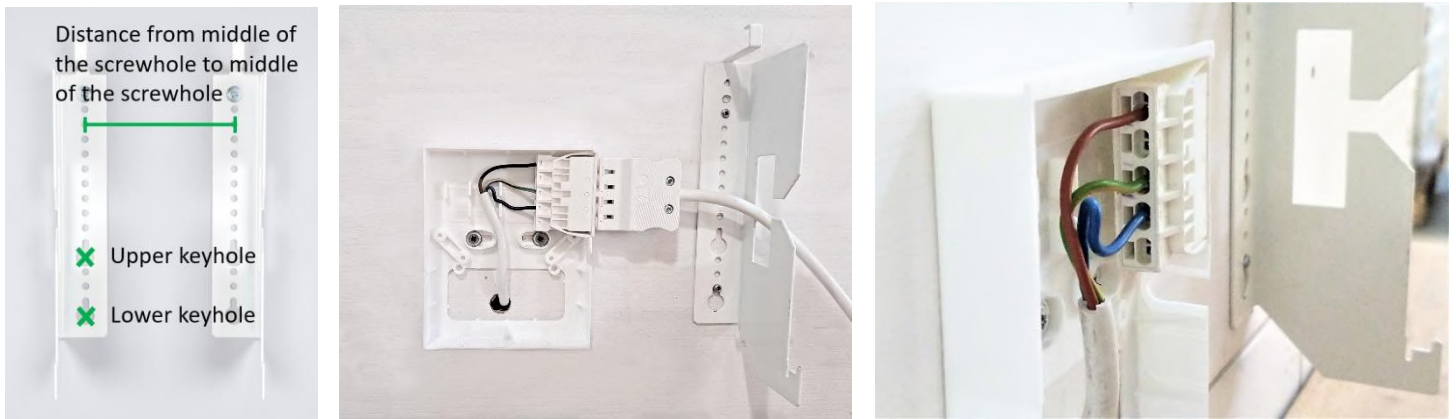

Note safety distances when mounting the heater on a wall. The safety distance is 50mm on each side and 100mm upwards. The recommended minimum height is 50mm off the floor. The thermostat adds 50mm to the width. The distance from the wall to the front surface of Walo heaters is 110mm and 75mm to the front surface of Warma and Wahva heaters, but 100mm to the thermostat's front surface.

- 1) Place the heater on the floor against the wall with wall brackets in place.
- 2) Check the correct mounting location. Mark the locations of the top ends of the wall brackets on the wall.
- 3) Remove the brackets off the heater and place them upright on the floor to the points you marked.
- 4) Tighten the screw in the upper big fastening hole of the left bracket standing on the floor against the wall.
- 5) Remove the bracket and set it to rest on the screw by the lower keyhole of the bracket. Tighten the upper screws.
- 6) Repeat the same for the right-hand bracket. The heater is now placed a minimum of 50mm off the floor, as recommended.

## Electrical connection

Install the junction box on the wall behind the heater. The recommended height of the junction box's center is approximately 120mm off the floor. The input tube should be positioned at approximately 100mm off the floor. The electrical wiring diagram contains wiring instructions.

If a heater is parallelly mounted, the master heater's junction box connector no. 3 is connected to the parallel heater's connector no. 1.

Walo, Warma ja Wahva heaters can be made into parallel heaters by turning the control knob into its extreme position, by taking off the knob and then replacing it with the empty knob cover that is supplied with the junction box. The combined power of the master and parallel heaters must not exceed 2300 Watts.

The thermostat has an eco-temperature of 5-35 °C, but ecoControl application must be downloaded to use this. With the app, you can control the temperature on a 24-hour 7-day timer or with a Home/Away switch which is activated when you connect a line-to-neutral voltage to the connector no. 2. Any line to neutral voltage (L1, L2 or L3) is suitable. The temperature change for the Home/Away switch is controlled by the ecoControl application.

The heaters have an ingress protection rating IP34 which makes them splash-proof, but their junction box IP21 is drip-proof. When placing these in a washroom or sauna, you should consult an electrician. If a higher IP rating is required for the junction box, the plug can be removed and connected in an IP44 rated junction box with membrane cable glands.

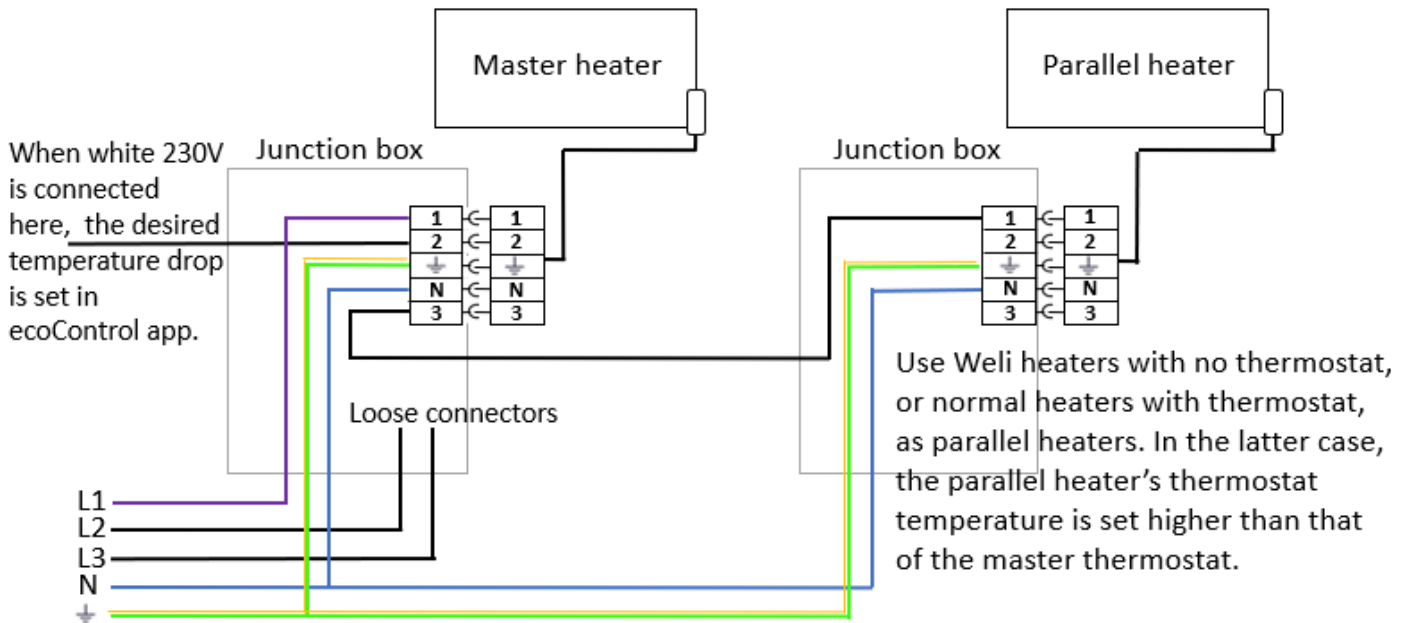

**Electrical wiring:**

- Yellow-green is protective grounding.
- Blue is working zero N.
- Brown is heater's input supply 230V to the connector no. 1.
- Black is the input supply of the master heater to the parallel heater's connector 230V no. 3.
- White is the temperature change/drop from current temperature when 230V is supplied to connector no. 2 (any line to neutral voltage is suitable (L1, L2 or L3)). The change is adjusted in ecoControl app.
- The protective grounding of the parallel heater is normally connected to the neutral conductor.
- Black no. 3 of the master thermostat is connected to the brown no. 1 of the parallel heater.

**Operation**

Switch the power on to position I on the O/I switch. It will take approximately 15 seconds for the thermostat to load itself, so there is a slight delay in the light turning on. Set the desired temperature on a scale of 5-35 °C. If the heater's power is appropriate for the space, the thermostat will keep the temperature stable.

A mounting bracket has a tilting piece which allows you to vacuum-clean the backside of the heater. A child protective button cover prevents children from adjusting the thermostat temperature. The heater oil is non-freezing and has a pour point of -42 °C, so the heater will not be damaged and will remain in working condition even if left in cold conditions for a long time

The heater must not be covered. If the surface temperature rises too high due to it being covered, for example, the overheating trigger switches off the electric current of the heater at 100 °C, and the heater starts to cool off. Let it cool off, then tilt it and push the reset button at the back side. Your heater is fully functional again.



## ecoControl application

ecoControl is a smartphone application. The application allows you to monitor and control the EW thermostats of Warmos Walo, Warma and Wahva radiators. ecoControl application and the Bluetooth controllable EW Ecodesign thermostat form an easy-to-use and cost-effective pair that complies with the strict EU Ecodesign directive. Download the app free of charge from Google Play or App Store by searching with the word “ecoControl” or by using the QR codes below.

Turn on the Bluetooth on your phone. Launch the application and select the desired language from the app settings icon on the Home screen. Connect your phone to the thermostat. You will find more detailed instructions in the application. See “Get support” button. With the application you can do the following:

- adjust temperature drop values on an hourly basis for a week
- adjust temperature values for a separate Home/Away switch
- select another temperature range for the control knob
- calibrate the thermostat
- limit the heater’s output power
- adjust the brightness of the thermostat led
- view temperature history

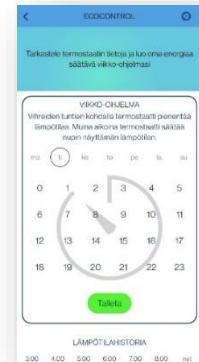

## Maintenance

When properly positioned and installed, Warmos heaters are durable and long-lasting and do not require actual maintenance. However, we recommend wiping dust and other impurities off the heater surface from time to time. The surface can be wiped with a damp cloth. In case of problems, consult the manufacturer or an electrician.

## Warranty

Frame warranty 10 years, thermostat warranty 2 years.

**Thank you for choosing Warmos!**

### MANUFACTURER

Warmos Heating Ltd  
Muurlantie 510  
FI-25130 Muurla  
Tel. +358 44 7217112  
info@warmos.fi  
www.warmos.fi